



Features

- Shielded Construction
- LCP Plastic Base
- RoHS, Halogen Free and REACH compliance

General Specifications

- Storage temp range: -40°C to +125°C
- Operating temp range: -40°C to +125°C
- Moisture Sensitivity Level(MSL): 1

Package

- MSS5022 - 500 PCS/Reel



► Shape and Dimensions (Unit:mm) Recommended Layout

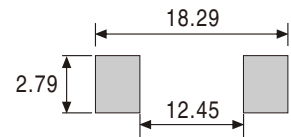
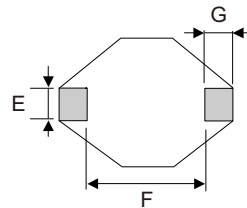
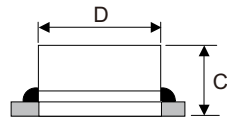
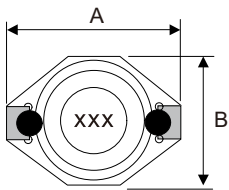

Type	A (max)	B (max)	C (max)	D (±0.3)	E (±0.2)	F (±0.3)	G (±0.2)
MSS5022	18.54	15.24	7.62	12.70	2.54	12.70	2.54

► Electrical Characteristics For MSS5022 Series

Part Number	Inductance [μH]	DCR(max) [Ω]	SRF(Typ) [MHz]	Isat (max) [A]	Irms (max) [A]
MSS5022-100M	10 ±20%	0.040	30	8.0	3.9
MSS5022-150M	15 ±20%	0.048	20	7.0	3.4
MSS5022-220M	22 ±20%	0.059	18	6.0	3.1
MSS5022-330M	33 ±20%	0.075	14	5.0	2.8
MSS5022-470M	47 ±20%	0.097	10	4.0	2.4
MSS5022-680M	68 ±20%	0.138	9	3.0	2.0
MSS5022-101M	100 ±20%	0.207	7	2.4	1.7
MSS5022-151M	150 ±20%	0.293	6	2.1	1.3
MSS5022-221M	220 ±20%	0.470	5	1.9	1.1
MSS5022-331M	330 ±20%	0.780	4	1.1	0.86
MSS5022-471M	470 ±20%	1.080	6	1.1	0.73
MSS5022-681M	680 ±20%	1.400	2.5	1.0	0.64
MSS5022-102M	1000 ±20%	2.010	2	0.8	0.53

- Inductance tested at 100kHz
- Heat Rating Current (Irms): Current that cause the temperature 40°C rise from 25°C
- Saturation Current (Isat): DC current at which the inductance drops 10% from its value without current