

## Features

- EMI Filtration
- Regged construction
- CSA,CE,VCCI
- High reliability
- EMI/RFI suppression
- Long term stability

## Applications

- EMI/RFI Suppression is required
- Noise Filtering
- Power Supplies Cable
- Switching Regulators Cable

## Physical & Electrical Characteristics

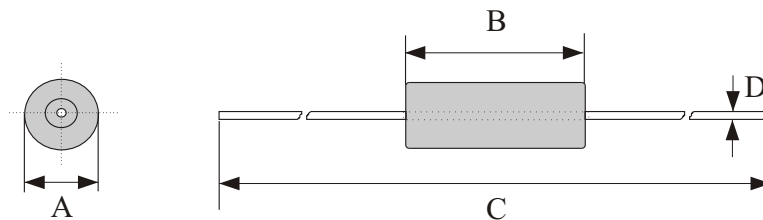

Part Number	A	B	C	D	Impedance @25MHz [Ω](Min)	Impedance @25MHz [Ω](Min)
FB - 2515	2.5 ± 0.2	1.5 ± 0.15	62 ± 2.0	0.65	5	20
FB - 2530	2.5 ± 0.2	3.0 ± 0.2	62 ± 2.0	0.65	8	25
FB - 2540	2.5 ± 0.2	4.0 ± 0.2	62 ± 2.0	0.65	12	32
FB - 2575	2.5 ± 0.2	7.0 ± 0.3	62 ± 2.0	0.65	20	58
FB - 3530	3.5 ± 0.2	3.0 ± 0.3	62 ± 2.0	0.65	13	65
FB - 3545	3.5 ± 0.2	4.5 ± 0.3	62 ± 2.0	0.65	20	45
FB - 3547	3.5 ± 0.2	4.7 ± 0.3	62 ± 2.0	0.65	20	45
FB - 3550	3.5 ± 0.2	5.0 ± 0.3	62 ± 2.0	0.65	20	50
FB - 3560	3.5 ± 0.2	6.0 ± 0.3	62 ± 2.0	0.65	20	80
FB - 3578	3.5 ± 0.2	7.8 ± 0.3	62 ± 2.0	0.65	28	90
FB - 3583	3.5 ± 0.2	8.3 ± 0.3	62 ± 2.0	0.65	30	100
FB - 3590	3.5 ± 0.2	9.0 ± 0.4	62 ± 2.0	0.65	60	100
FB - 3510	3.5 ± 0.2	10 ± 0.4	62 ± 2.0	0.65	50	130
FB - 3512	3.5 ± 0.2	12 ± 0.5	62 ± 2.0	0.65	45	145
FB - 3514	3.5 ± 0.2	14 ± 0.5	62 ± 2.0	0.65	60	150