

# T CORES

**Meisongbei**

Material: M3K, M2, M3, M5K, M7K, M10K

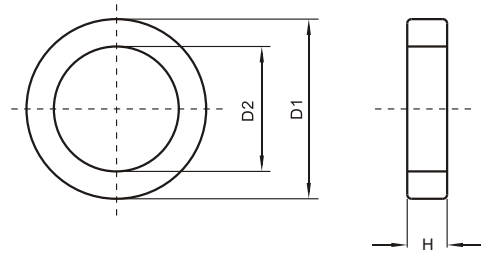

Type	Dimension(mm)			Weight (g)	Effective Parameter				AL(nH/N <sup>2</sup> )					
	D1	D2	H		C1 (mm <sup>-1</sup> )	Le (mm)	Ae (mm <sup>2</sup> )	Ve (mm <sup>3</sup> )	M3K (±20%)	M2 (±20%)	M3 (±20%)	M5K (±20%)	M7K (±20%)	M10K (±20%)
T6X3X3	6.0±0.3	3.0±0.3	3.0±0.2	0.3	3.13	14.1	4.5	63.5	1300	1150	1000	2250	3150	4200
T9X5X3	9.0±0.3	5.0±0.3	3.0±0.2	0.6	3.61	21.4	6.1	134	1100	990	850	1900	2600	3500
T10X6X5	10.0±0.3	6.0±0.3	5.0±0.3	1.0	2.46	25.1	10.2	256	1600	1400	1200	2800	3800	5100
T12.7X7.92X6.35	12.7±0.4	7.97±0.3	6.35±0.3	2.3	2.09	31.2	14.9	465	1900	1680	1440	3300	4500	6000
T14X9X5	14.0±0.4	9.0±0.3	5.0±0.3	2.1	2.89	36	12.5	452	1400	1240	1060	2400	3300	4400
T16X8X5	16.0±0.3	8.0±0.3	5.0±0.3	3.5	1.81	36.2	20	724	2200	1940	1660	3800	5200	6900
T16X12X8	16.0±0.3	12.0±0.3	8.0±0.3	3.4	2.73	43.4	15.9	689	1500	1300	1100	2500	3500	4600
T18X10X6.335	18.0±0.4	10.0±0.3	6.35±0.3	5.3	12.68	41.5	24.7	1020	2400	2100	1800	4100	5600	7500
T18X10X10	18.0±0.4	10.0±0.3	10.0±0.3	8.3	1.07	41.5	38.9	1610	3800	3300	2800	500	8800	11800
T20X10X7	20.0±0.4	10.0±0.3	8.0±0.3	8.0	1.14	46.6	26.8	1650	3200	2800	2300	6400	8600	12400
T20X10X10	20.0±0.4	10.0±0.3	10.0±0.3	10.5	1.08	52.4	36.2	2240	4200	3800	3300	6930	920	13860
T22X14X8	20.0±0.4	14.0±0.4	12.7±0.3	8.2	1.74	54.7	31.4	1720	2300	2000	1700	4000	5400	7200
T22X14X10	22.0±0.4	14.0±0.4	10.0±0.3	9.5	1.24	64.8	31.4	2460	3600	3200	2800	6800	8000	10000
T22X14X12.7	22.0±0.4	14.0±0.4	12.7±0.3	13.6	1.02	72.6	31.4	3780	3800	3400	3000	7800	9200	11500
T25X15X10	25.0±0.4	15.0±0.4	10.0±0.3	14.8	0.98	60.2	63.6	3827	2900	2600	2200	5400	7500	9200
T25X15X12	25.0±0.4	15.0±0.4	12.0±0.3	17.5	1.03	60.2	58.7	3530	3900	3400	2900	6700	9200	12000
T25X15X13	25.0±0.4	15.0±0.4	13.0±0.3	19	0.95	60.2	63.6	3830	4300	3700	3200	7300	10000	13300
T10X6X2.8	10.0±0.3	6.0±0.3	2.8±0.2	0.6	4.58	25.1	5.48	138		800				
T10X6X3.5	10.0±0.3	6.0±0.3	3.5±0.2	0.75	3.66	25.1	6.85	172		950				
T10X6X4	10.0±0.3	6.0±0.3	4.0±0.2	0.9	3.2	25.1	7.82	196		1100				
T28X12.4X7.6	28.0±0.4	12.4±0.3	7.6±0.3	23	1.01	56.9	56.1	3195		2900				
T28X16X16	28.0±0.4	16.0±0.4	16.0±0.3	31	0.92	75.2	58.5	4860	5600	5100	4600	8950	12500	17900
T28X18X13	28.0±0.4	18.0±0.4	13.0±0.3	23	0.96	72.4	63.2	4320	4000	3500	3000	5500	7600	11000
T28X18X14	31.0±0.5	18.0±0.5	14.0±0.4	33.6	0.98	76.2	79.2	6750	4800	4300	3800	8600	10500	14000
T31X19X13	31.0±0.5	19.0±0.5	13.0±0.4	29	0.99	75.5	76.5	5770	4100	3600	3100	7000	9500	12700
T31X19X15	31.0±0.5	19.0±0.5	15.0±0.4	31.5	1	77.6	81.2	6300	4700	4200	3701	7800	11200	13600
T36X23X15	31.0±0.5	23.0±0.5	15.0±0.4	44	0.929	89.6	96.5	865	4300	3800	3200	7400	10100	13500
T38X19X13	36.0±0.5	19.0±0.5	13.0±0.4	52.5	0.7	86.1	123	10590	5800	5000	4300	9900	13500	18000
T48X30X15	38.0±0.5	30.0±0.5	15.0±0.5	75	0.89	118	133	15700	4500	3900	3400	7800	10600	14000
T63X38X12.7	63.0±1.0	38.0±0.5	12.7±0.5	106	0.62	146	235	34300	6500	4900	17200	6840	10200	13690

SHANGHAI MEISONGBEI ELECTRONICS CO.,LTD

NO.528 Kangding Road, Jing'An, Shanghai Tel:0086-21-62883517 Fax:0086-21-62883519 www.meisongbei.com