

SMD Semi-Shielded Power Inductor - SNR5040 Series *Meisongbei*



Features

- Magnetic-resin Shielded reduces noise
- Inductance Range: 1uH - 220uH
- Rated current up to 7.35A
- Small and very Thin inductor

Application

- LED Lighting,
- Automotive systems,
- Notebooks, desktop computers, servers, graphic cards.

General Specifications

- Storage temp range: -40°C to +85°C
- Operating temp range: -40°C to +125°C
- Resistance to Soldering Heat +260°C for 5-10 Sec.

► Dimensions & Configurations (Unit:mm)

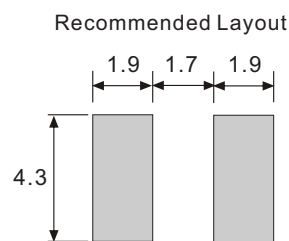
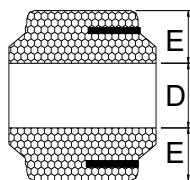
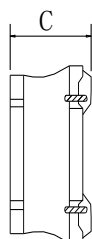
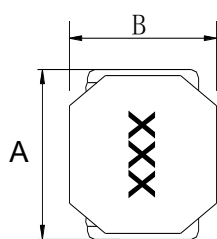

Type	A	B	C	D	E
SNR5040	5.0±0.2	5.0±0.2	4.0Max	2.0±0.2	1.5±0.2

► Electrical Characteristics For SNR5040 Series

Part Number	Inductance [uH]	DCR(max) [mΩ]	Isat [A] (Max.)
SNR5040-1R0N	1.0±30%	18	7.35
SNR5040-1R5N	1.5±30%	28	5.00
SNR5040-2R2N	2.2±30%	28	4.90
SNR5040-3R3M	3.3±20%	34	3.95
SNR5040-4R7M	4.7±20%	42	3.50
SNR5040-6R8M	6.8±20%	59	2.90
SNR5040-100M	10±20%	78	2.30
SNR5040-150M	15±20%	104	2.00
SNR5040-220M	22±20%	169	1.60
SNR5040-270M	27±20%	208	1.40
SNR5040-330M	33±20%	234	1.30
SNR5040-470M	47±20%	403	1.02
SNR5040-560M	56±20%	442	1.00
SNR5040-680M	68±20%	650	0.85
SNR5040-101M	100±20%	728	0.66
SNR5040-221M	220±20%	2340	0.40