

SMD Semi-Shielded Power Inductor - SNR252010 Series *Meisongbei*



Features

- 2.5mmx2.0mmx1.05mm Shielded
- Inductance Range: 0.47uH - 22uH
- Current Range: 0.4A - 2.5A
- Small and very Thin inductor

Application

- LED Lighting,
- Automotive systems,
- Notebooks, desktop computers, servers, graphic cards.

General Specifications

- Storage temp range: -40°C to +85°C
- Operating temp range: -40°C to +125°C
- Resistance to Soldering Heat +260°C for 5-10 Sec.

► Dimensions & Configurations (Unit:mm)

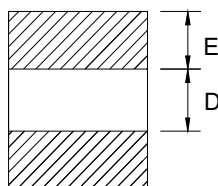
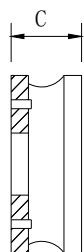
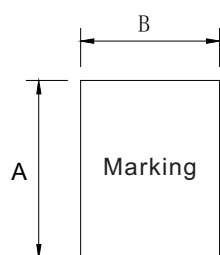

Recommended Layout

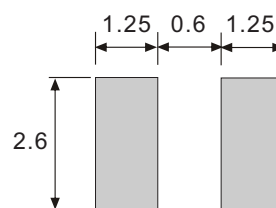

Type	A	B	C	D	E
SNR252010	2.5±0.3	2.0±0.35	1.05Max	0.9±0.2	0.83±0.2

► Electrical Characteristics For SNR252010 Series

Part Number	Inductance [uH]	DCR(max) [mΩ]	Isat [A] (Max.)
SNR252010-R47N	0.47±30%	44	2.50
SNR252010-R68N	0.68±30%	65	2.45
SNR252010-1R0N	1.0±30%	80	2.05
SNR252010-1R5N	1.5±30%	117	1.70
SNR252010-2R2N	2.2±30%	148	1.55
SNR252010-3R3M	3.3±20%	228	1.10
SNR252010-4R7M	4.7±20%	323	0.95
SNR252010-6R8M	6.8±20%	451	0.80
SNR252010-100M	10±20%	584	0.65
SNR252010-150M	15±20%	954	0.45
SNR252010-220M	22±20%	1548	0.40

- Inductance tested at 100kHz, 1.0Vrms, 0.0A_{dc}
- Heat Rating Current (I_{rms}): Current that cause the temperature 40°C rise from 25°C
- Saturation Current (I_{sat}): DC current at which the inductance drops 30% from its value without current