

SMD Semi-Shielded Power Inductor - SNR4018 Series *Meisongbei*



Features

- Magnetic-resin Shielded reduces noise
- Inductance Range: 1uH - 220uH
- Rated current up to 4.5A
- Small and very Thin inductor

Application

- LED Lighting,
- Automotive systems,
- Notebooks, desktop computers, servers, graphic cards.

General Specifications

- Storage temp range: -40°C to +85°C
- Operating temp range: -40°C to +125°C
- Resistance to Soldering Heat +260°C for 5-10 Sec.

► Dimensions & Configurations (Unit:mm)

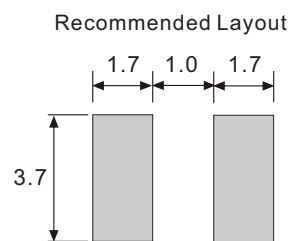
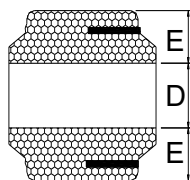
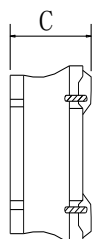
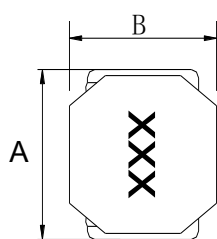

Type	A	B	C	D	E
SNR4018	4.0±0.2	4.0±0.2	1.8Max	1.4±0.2	1.3±0.2

► Electrical Characteristics For SNR4018 Series

Part Number	Inductance [uH]	DCR(max) [mΩ]	Isat(max) [A]
SNR4018-1R0N	1.0±30%	33	4.50
SNR4018-1R2N	1.2±30%	48	3.50
SNR4018-2R2N	2.2±30%	59	2.70
SNR4018-3R3M	3.3±20%	84	2.15
SNR4018-4R7M	4.7±20%	117	2.00
SNR4018-5R6M	5.6±20%	130	1.65
SNR4018-6R8M	6.8±20%	143	1.60
SNR4018-100M	10±20%	234	1.30
SNR4018-150M	15±20%	325	0.95
SNR4018-220M	22±20%	468	0.80
SNR4018-330M	33±20%	689	0.65
SNR4018-470M	47±20%	845	0.57
SNR4018-680M	68±20%	1300	0.46
SNR4018-101M	100±20%	1950	0.41
SNR4018-151M	150±20%	3120	0.32
SNR4018-221M	220±20%	4800	0.28