

## Features

- Power Range: 120-200W
- Vertical and Horizontal mount
- Flat wire winding on closed magnetic path core
- Smaller winding form factor
- Flat wire dramatically reduces parasitic capacitance
- High magnetic saturation characteristics
- High attenuation to the normal mode noise
- Automatic winding for improved reliability

## Applications

- Rated Voltage: AC/DC 250V
- Test Condition: 1KHz 0.25V
- Operating Temperature: -25°C to +125°C
- Storage Temperature: -25°C to +100°C
- Withstanding Voltage: 1.5KVAC 60SEC.



## Dimensions & Configurations (Unit:mm)

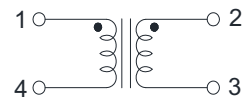
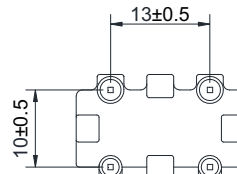
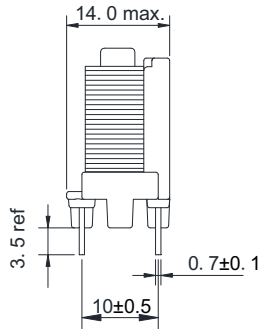
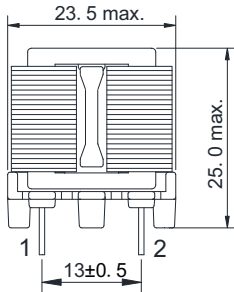

Suggest PCB hole:  $\geq \Phi 1.2\text{mm}$

V : Vertical Type

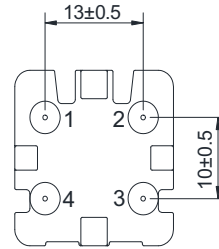
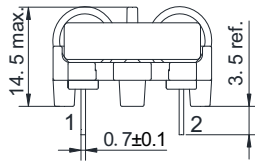
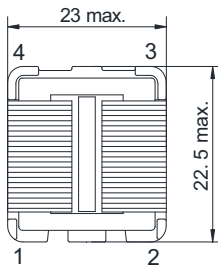

H : Horizontal Type

## Electrical Characteristics For SQ1918V / SQ1918H Series

Part Number		Inductance [mH] (Min.)	Wire (mm)	DCR [mΩ] (Max.)	Rated Current [A]
SQ1918V-202U	SQ1918H-202U	2	0.4*1.5	50	7.2
SQ1918V-502U	SQ1918H-502U	5	0.3*1.5	100	5.5
SQ1918V-602U	SQ1918H-602U	6	0.25*1.5	100	4.5
SQ1918V-103U	SQ1918H-103U	10	0.2*1.5	145	3.6
SQ1918V-153U	SQ1918H-153U	15	0.2*1.5	150	3.0
SQ1918V-203U	SQ1918H-203U	20	0.15*1.0	260	1.8
SQ1918V-253U	SQ1918H-253U	25	0.13*1.0	340	1.5
SQ1918V-303U	SQ1918H-303U	30	0.13*1.0	350	1.5