

### Features

- Power Range: 300-500W
- Vertical and Horizontal mount
- Flat wire winding on closed magnetic path core
- Smaller winding form factor
- Flat wire dramatically reduces parasitic capacitance
- High magnetic saturation characteristics
- High attenuation to the normal mode noise
- Automatic winding for improved reliability

### Applications

- Rated Voltage: AC/DC 250V
- Test Condition: 1KHz 0.25V
- Operating Temperature: -25°C to +125°C
- Storage Temperature: -25°C to +100°C
- Withstanding Voltage: 1.5KVAC 60SEC.



## ► Dimensions & Configurations (Unit:mm)

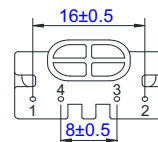
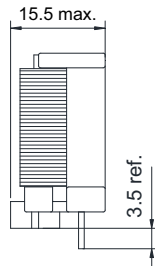
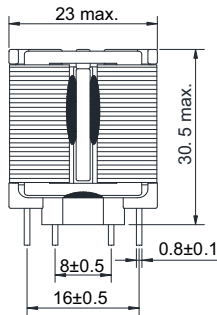

V : Vertical Type

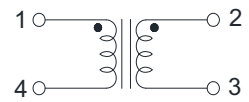

Suggest PCB hole:  $\geq \Phi 1.4\text{mm}$

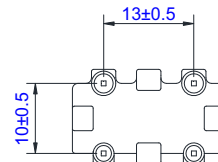
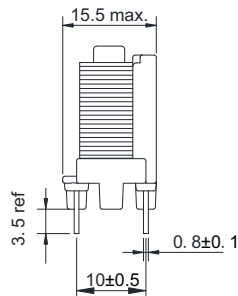
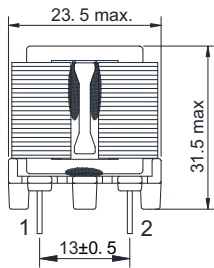

V1 : Vertical Type

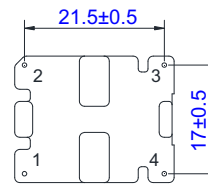
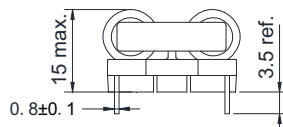
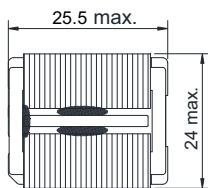

H : Horizontal Type

## ► Electrical Characteristics For SQ2418V / SQ2418V1 / SQ2418H Series

Part Number			Inductance [mH] (Min.)	Wire (mm)	DCR [mΩ] (Max.)	Rated Current [A]
SQ2418V-202U	SQ2418V1-202U	SQ2418H-202U	2	0.5*1.5	50	9.0
SQ2418V-502U	SQ2418V1-502U	SQ2418H-502U	5	0.4*1.5	75	7.0
SQ2418V-103U	SQ2418V1-103U	SQ2418H-103U	10	0.3*1.5	100	5.5
SQ2418V-123U	SQ2418V1-123U	SQ2418H-123U	12	0.25*1.5	100	4.5
SQ2418V-153U	SQ2418V1-153U	SQ2418H-153U	15	0.2*1.5	100	3.0